

NORTH  
NY STATE PLANE  
LONG ISLAND ZONE  
2016 NYS ORTHOMETRIC  
AERIAL PHOTOGRAPHY

NYSDEC  
APPROVED AS PER TERMS  
AND CONDITIONS OF  
PERMIT NO. 14738-02455/7  
DATE 7/13/2021  
page 1 of 7

KEY	
	OLD ORANGE WETLAND FLAGS
	DEC FLAGS
	GPS LOCATIONS
	Corex_Debris

**CERTIFICATION & ALTERATION NOTE:**  
UNAUTHORIZED ALTERATION OR ADDITION TO A SURVEY MAP BEARING A LICENSED LAND SURVEYOR'S SEAL IS A VIOLATION OF SECTION 7209, SUB-DIVISION 2, OF THE NEW YORK STATE EDUCATION LAW. ONLY COPIES FROM THE ORIGINAL OF THIS SURVEY MARKED WITH AN ORIGINAL OF THE LAND SURVEYOR'S INKED SEAL OR EMBOSSED SEAL SHALL BE CONSIDERED TO BE VALID TRUE COPIES. CERTIFICATIONS INDICATED HEREIN DENY THAT THIS SURVEY MAP WAS PREPARED IN ACCORDANCE WITH THE CURRENT EXISTING CODE OF PRACTICE FOR LAND SURVEYS ADOPTED BY THE NEW YORK STATE ASSOCIATION OF PROFESSIONAL LAND SURVEYORS. SAID CERTIFICATIONS SHALL RUN ONLY TO THE PERSON(S) FOR WHOM THE SURVEY IS PREPARED, AND ON THEIR BEHALF TO THE TITLE COMPANY, LENDING INSTITUTION AND/OR GOVERNMENTAL AGENCY LISTED HEREIN, AND THE SUCCESSORS AND/OR ASSIGNEES OF THE LENDING INSTITUTION. CERTIFICATIONS ARE NOT TRANSFERABLE TO ADDITIONAL INSTITUTIONS OR SUCCESSOR OWNERS. LOCATIONS OF UNDERGROUND IMPROVEMENTS OR ENCROACHMENTS, IF ANY EXIST EXCEPT AS SHOWN HEREIN, ARE NOT KNOWN AND ARE NOT COVERED BY THIS CERTIFICATION.  
COPYRIGHT 2019 F. MICHAEL HEMMER, L.S., P.C. ALL RIGHTS RESERVED

1 9/3/2020 JRH RESPONSE TO DEC COMMENTS FROM 12/31/19

Field No.	19-083
Drawn By	DMR
Checked By	DMR
Reviewed By	DMR
Date	30 JUL 2019

<b>MINI RAILROAD</b>	
PROPERTY SITUATE AT <b>MOORES LANE</b> VILLAGE OF GREENPORT, NY COUNTY OF SUFFOLK, TOWN OF SOUTHOLD DISTRICT 1000, SECTION 45, BLOCK 7, LOT 5.	
Prepared By <b>F. Michael Hemmer, L.S., P.C.</b> Professional Surveying Services PO Box 1328, Sag Harbor, New York 11963 (631) 725-7199 info@fmhls.com	
Sheet Title: <b>PROPOSED SITE PLAN</b>	Sheet <b>1 OF 1</b>







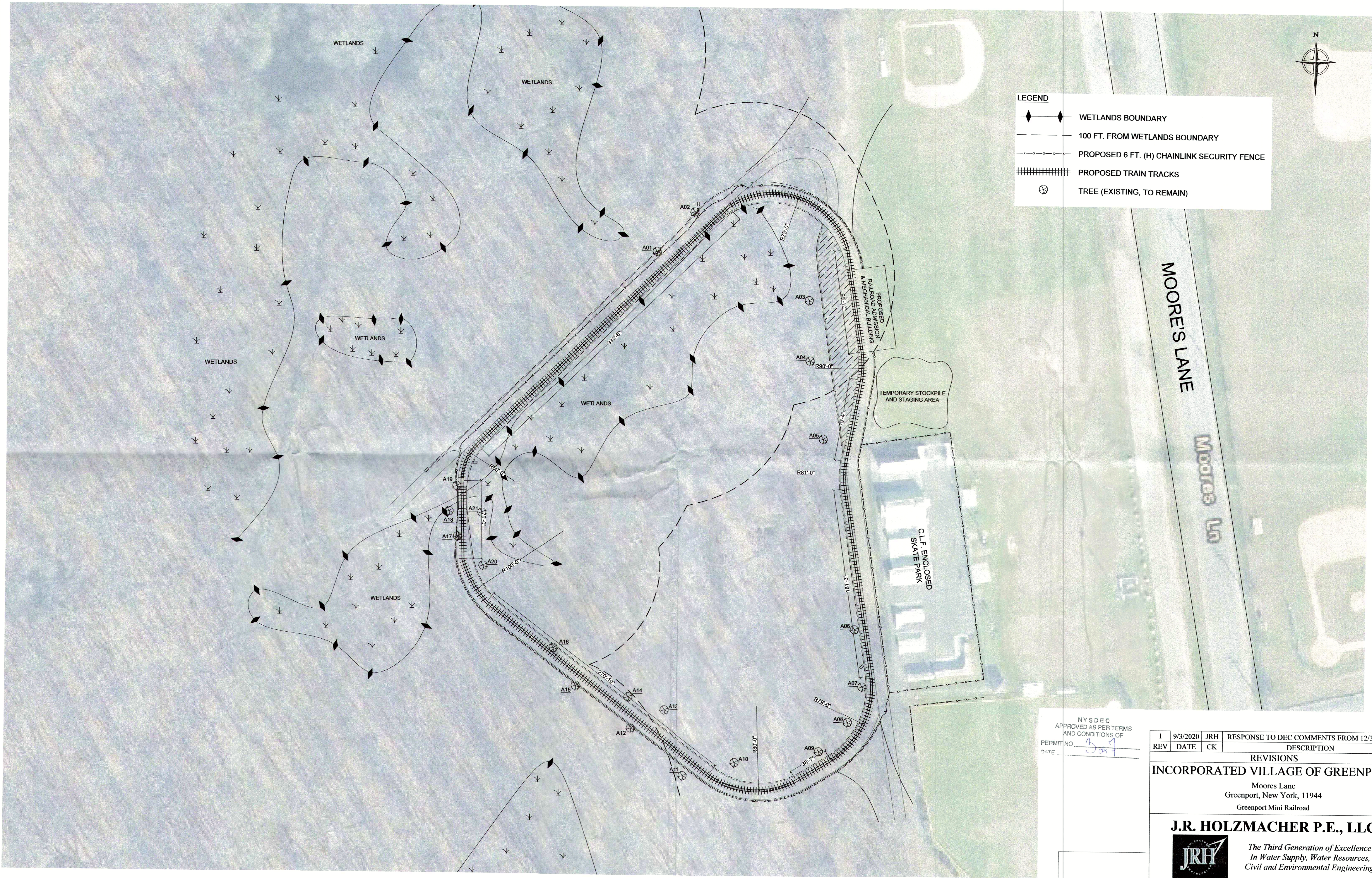

**LEGEND**

- WETLANDS BOUNDARY
- 100 FT. FROM WETLANDS BOUNDARY
- PROPOSED 6 FT. (H) CHAINLINK SECURITY FENCE
- PROPOSED TRAIN TRACKS
- TREE (EXISTING, TO REMAIN)

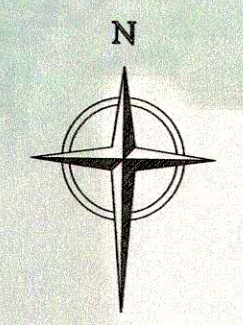

NYS DEC  
 APPROVED AS PER TERMS  
 AND CONDITIONS OF  
 PERMIT NO. 509  
 DATE: \_\_\_\_\_

REV	DATE	CHK	DESCRIPTION
1	9/3/2020	JRH	RESPONSE TO DEC COMMENTS FROM 12/31/19

**REVISIONS**

**INCORPORATED VILLAGE OF GREENPORT**

Moore's Lane  
 Greenport, New York, 11944  
 Greenport Mini Railroad

**J.R. HOLZMACHER P.E., LLC**

*The Third Generation of Excellence  
 In Water Supply, Water Resources,  
 Civil and Environmental Engineering*

3555 Veterans Memorial Highway, Suite A, Ronkonkoma, NY 11779  
 PHONE: (631) 234-2220 FAX: (631) 234-2221 E-MAIL: info@holzmacher.com

SHEET TITLE: <b>MINIATURE RAILROAD SITE PLAN &amp; TRACK DIMENSIONS</b>	
DESIGNED BY: NMS	SCALE: As Noted
REVIEWED BY: JRH	DATE: August 7th, 2020
PLAN SHEET BY: SC	PROJECT NO: GrptV 19-03

**1 SITE PLAN & TRACK DIMENSIONS**  
 SCALE: 1"=40'-0"

P:\2019\GrptV19-03 Mini Railroad\CAD\Map Tools\Legend\_Sheet - NYS DEC.dwg

ALTERATION OF THIS DOCUMENT EXCEPT BY A LICENSED PROFESSIONAL IS ILLEGAL.



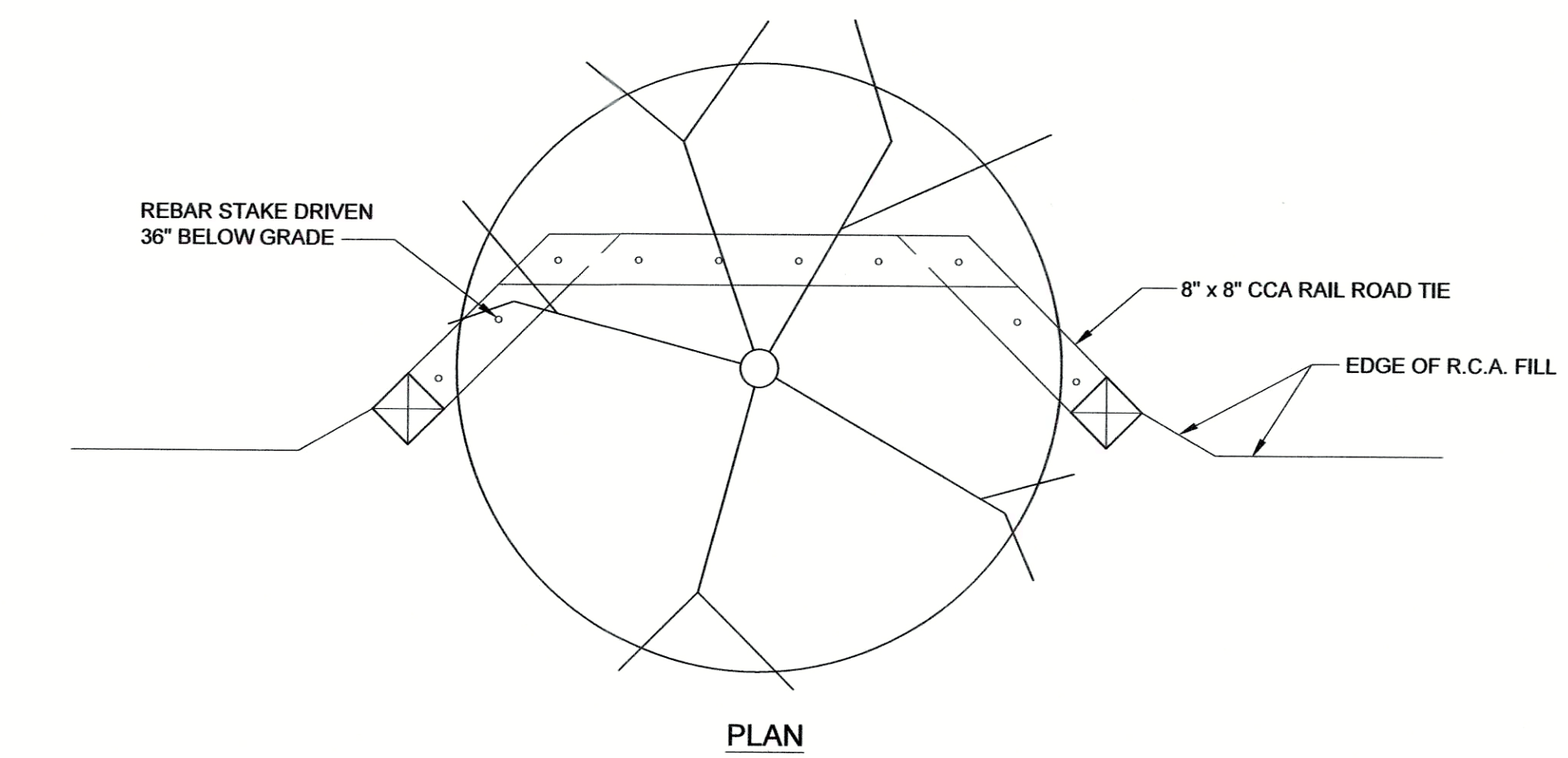

PLAN

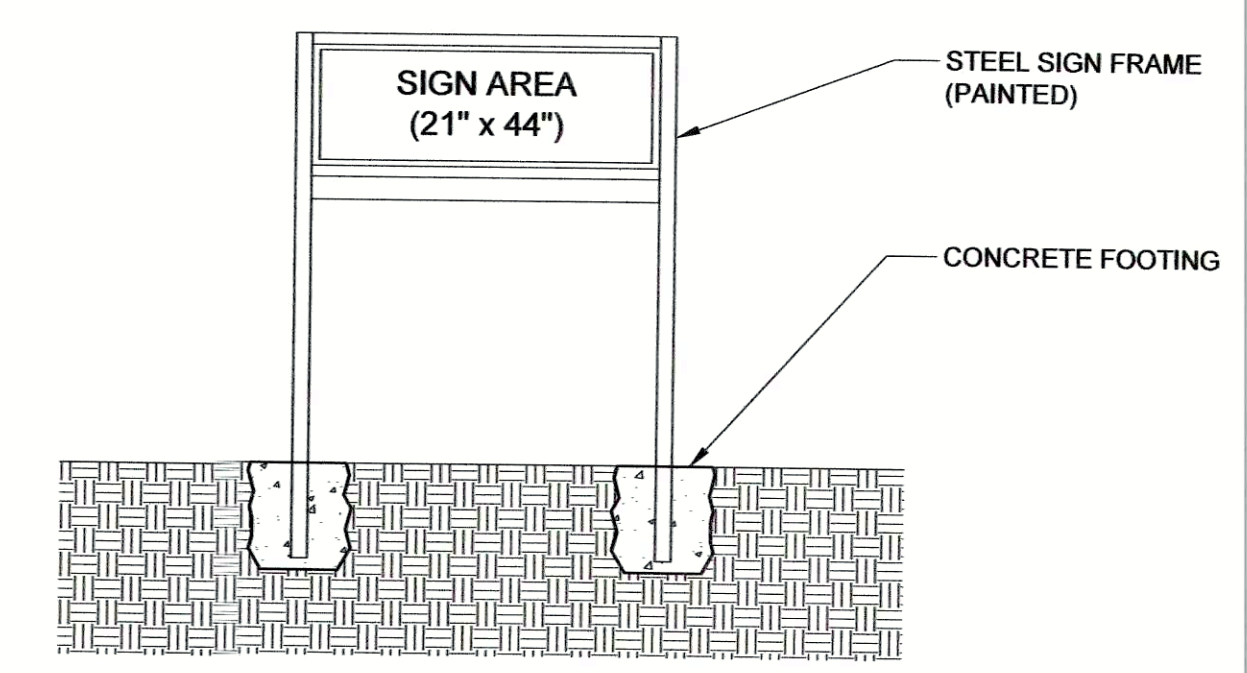

FRONT VIEW

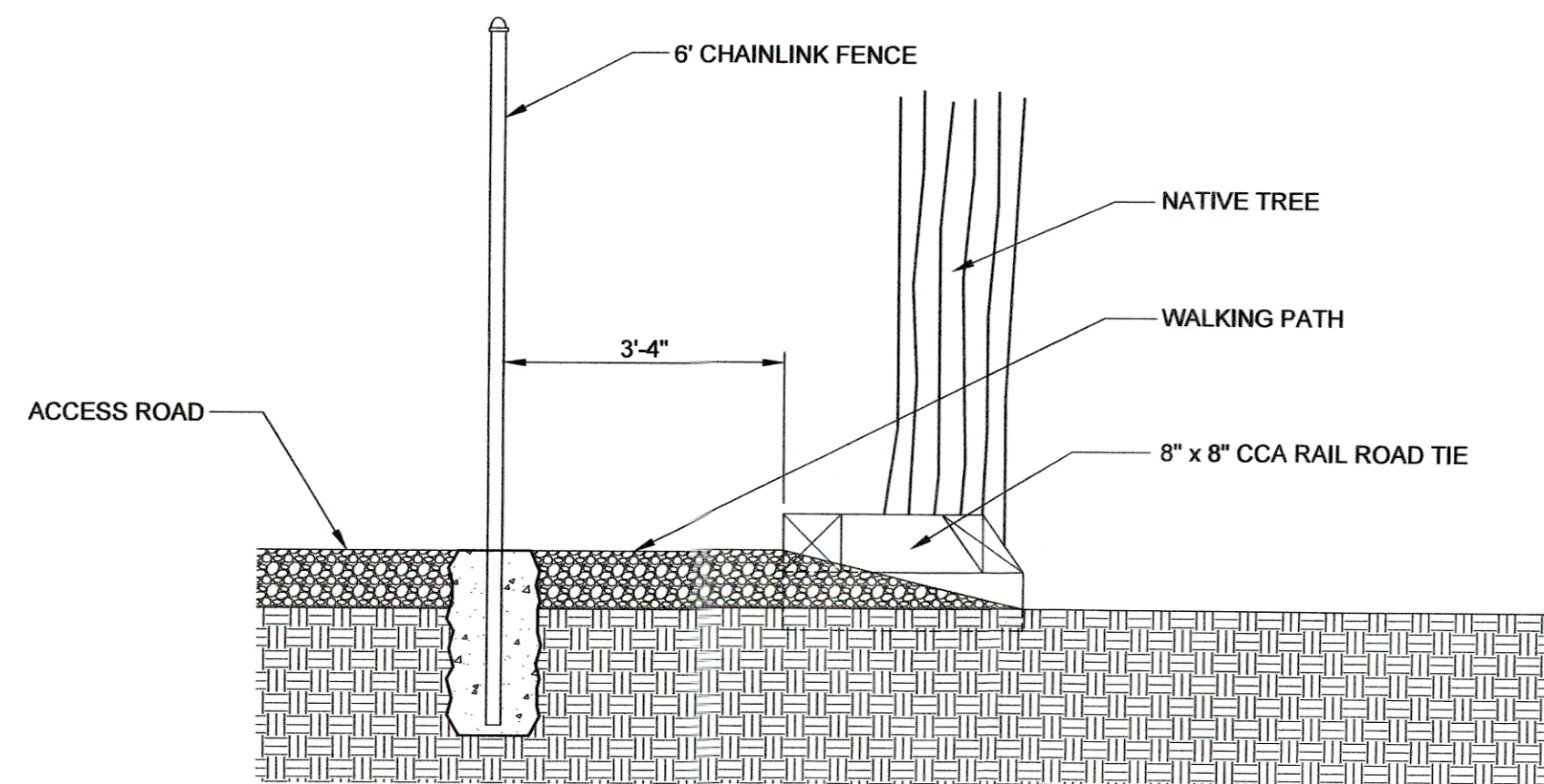

ELEVATION

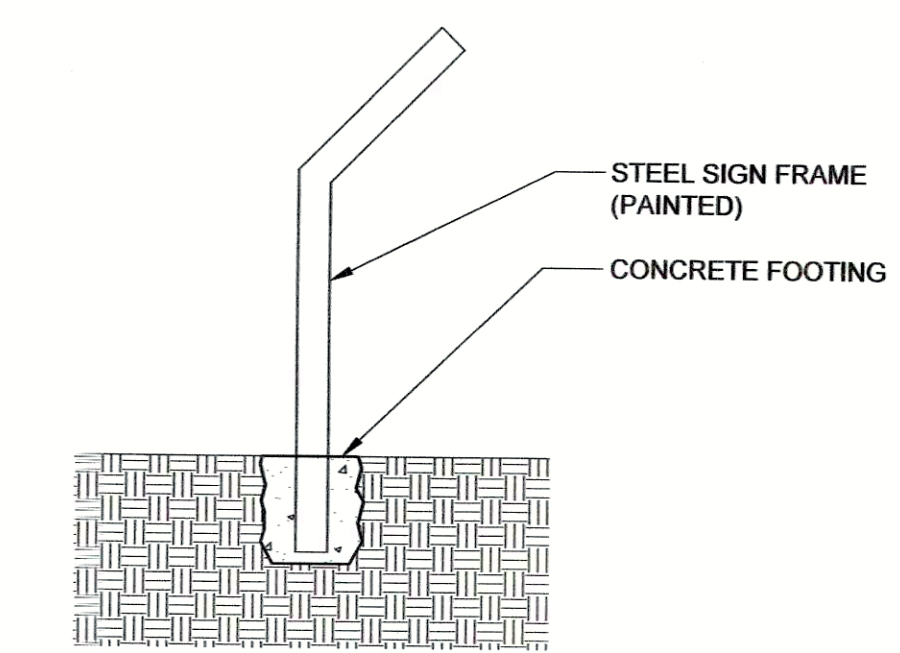

SIDE VIEW

1 TREE BOX DETAIL  
SCALE: 1/2"=1'-0"

2 INFORMATIONAL SIGN DETAIL  
SCALE: 1/2"=1'-0"

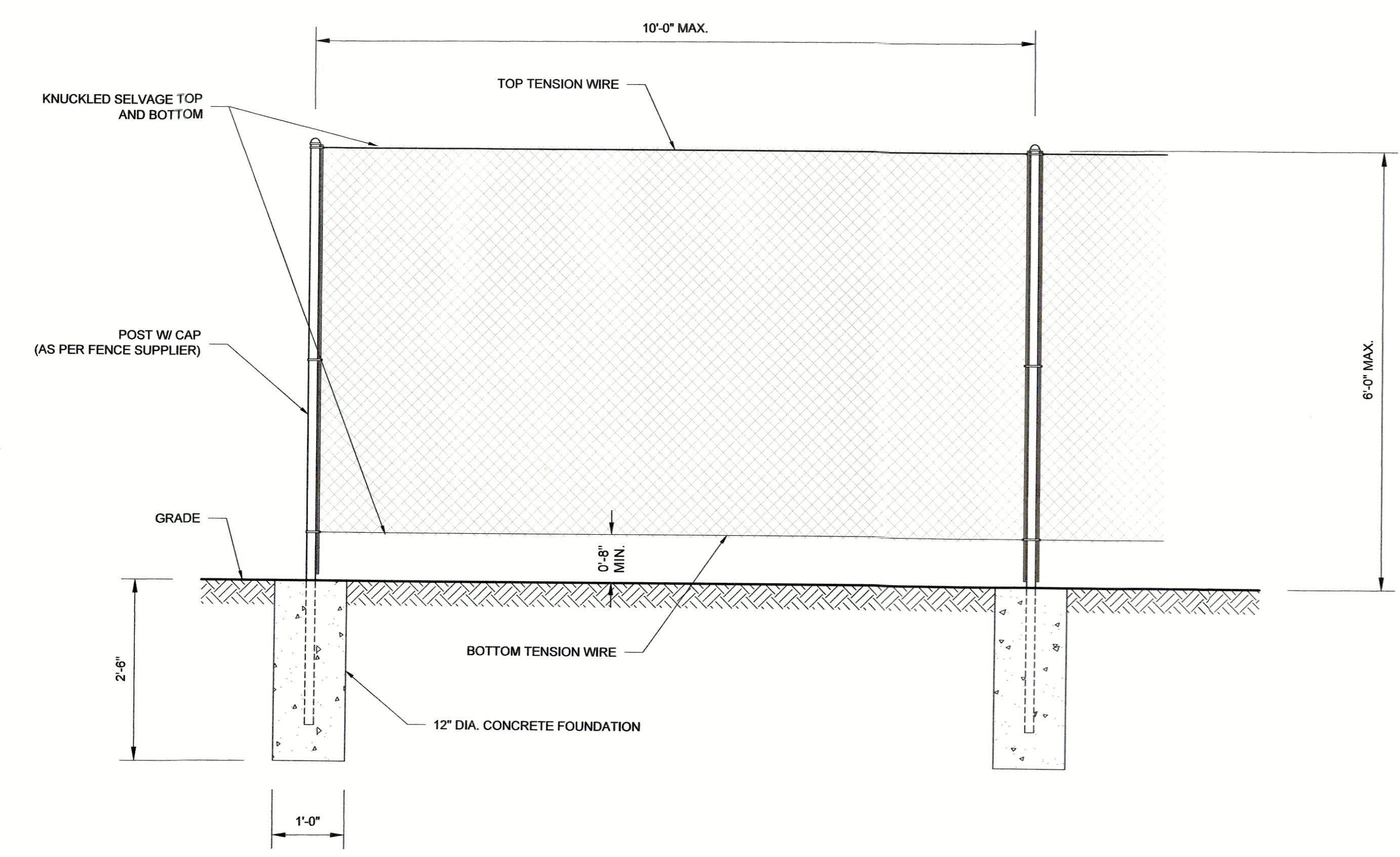

3 CHAIN LINK FENCE ELEVATION  
SCALE: 3/4"=1'-0"

NYS DEC  
APPROVED AS PER TERMS  
AND CONDITIONS OF  
PERMIT NO. 457  
DATE 1/27

1	9/3/2020	JRH	RESPONSE TO DEC COMMENTS FROM 12/31/19
REV	DATE	CK	DESCRIPTION

REVISIONS

**INCORPORATED VILLAGE OF GREENPORT**  
Moores Lane  
Greenport, New York, 11944  
Greenport Mini Railroad

**J.R. HOLZMACHER P.E., LLC**  
*The Third Generation of Excellence  
In Water Supply, Water Resources,  
Civil and Environmental Engineering*  
3555 Veterans Memorial Highway, Suite A, Ronkonkoma, NY 11779  
PHONE: (631) 234-2220 FAX: (631) 234-2221 E-MAIL: info@holzmacher.com

DESIGNED BY:	NMS	SCALE:	As Noted
REVIEWED BY:	JRH	DATE:	August 7th, 2020
PLAN SHEET BY:	SC	PROJECT NO.:	GrpIV 19-03



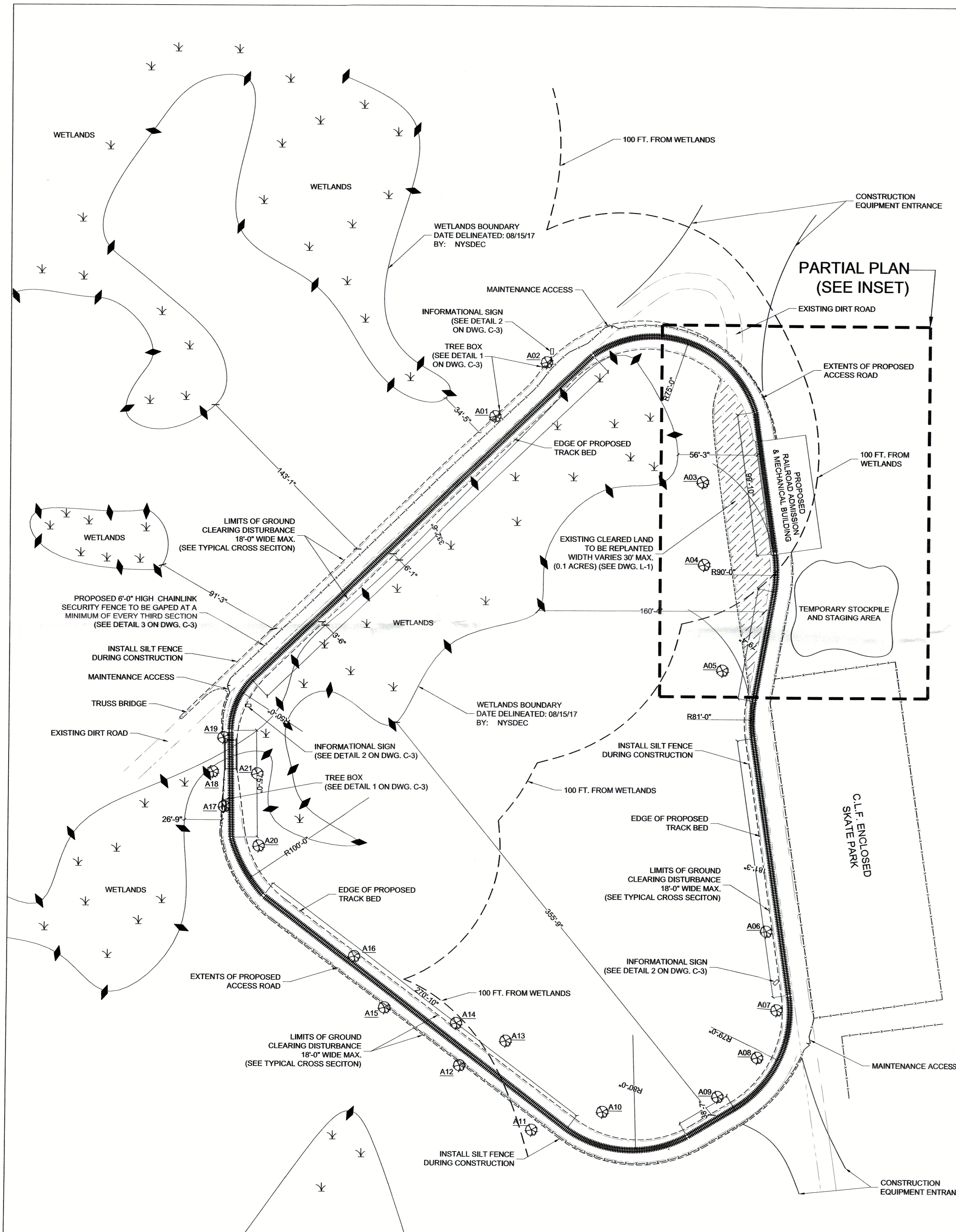

**PLANTING NOTES:**

- The Contractor shall locate and verify the existence of all public and private utilities, both above and below grade prior to starting work.
- The Contractor shall supply all plant materials in quantities sufficient to complete the planting shown on the drawings.
- All plant material shall conform to the guidelines established by the current American Standard for Nursery Stock, published by the Amer. Assoc. of Nurserymen.
- Required periods for planting are March 1 to June 15 and August 15 to December 1 unless otherwise written permission is approved.
- All plants shall bear the same relationship to finished grade as the plant's original grade before digging.
- All plants shall be subject to inspection by the Landscape Architect upon arrival at the site. Any plants exhibiting unhealed wounds, scrapes, cuts or bruises to the trunk or bark, and any major broken branches shall be rejected and replaced.
- All plants shall be balled and wrapped or container grown as specified. No container grown stock will be accepted if it is root bound. All root wrapping material made of synthetics, metal or plastics shall be completely removed at planting time.
- With container grown stock, the container shall be completely removed and the container ball shall be cut through the surface in two vertical locations.
- Prior to planting, the locations of all trees and shrubs shall be staked or marked for approval by the Landscape Architect, if requested by the Owner.
- The Landscape Architect reserves the right to select any or all plant material at the nursery prior to delivery, if requested by the Owner.
- All trees & shrubs shall be sprayed with an antidesiccant within 24 hours of planting.
- All plants shall be installed as per details & specifications.
- All plants and stakes, if used, shall be set plumb unless otherwise specified.
- All plants shall be watered thoroughly twice during the first 24 hour period after planting. All plants shall then be watered weekly as required.
- All planting beds shall have a min. 3" thick layer of shredded hardwood mulch OR 3" layer of river rock. Bare soil shall be left at the base of the plant to avoid trunk suffocation or rot.
- Planting holes shall be backfilled with the same soil that was removed. No soil amendments are required unless otherwise noted.
- Pruning of plant material after planting is limited to dead and damaged branches, or those that threaten the appearance and branching structure.
- All plants and trees shall be guaranteed by the planting contractor to be in a vigorous growing condition. Provision shall be made for a growth guarantee of at least one year after bond for all plant material. Replacements shall be made at the beginning of the first succeeding planting season. The contractor shall continue to make replacements until a plant shows vigorous and healthy growth for a period of one year from date of acceptance.
- Specifications shall follow Cornell Cooperative Extension Publication -Information Bulletin 24 - "Suggested Practices for Planting and Maintaining Trees and Shrubs".

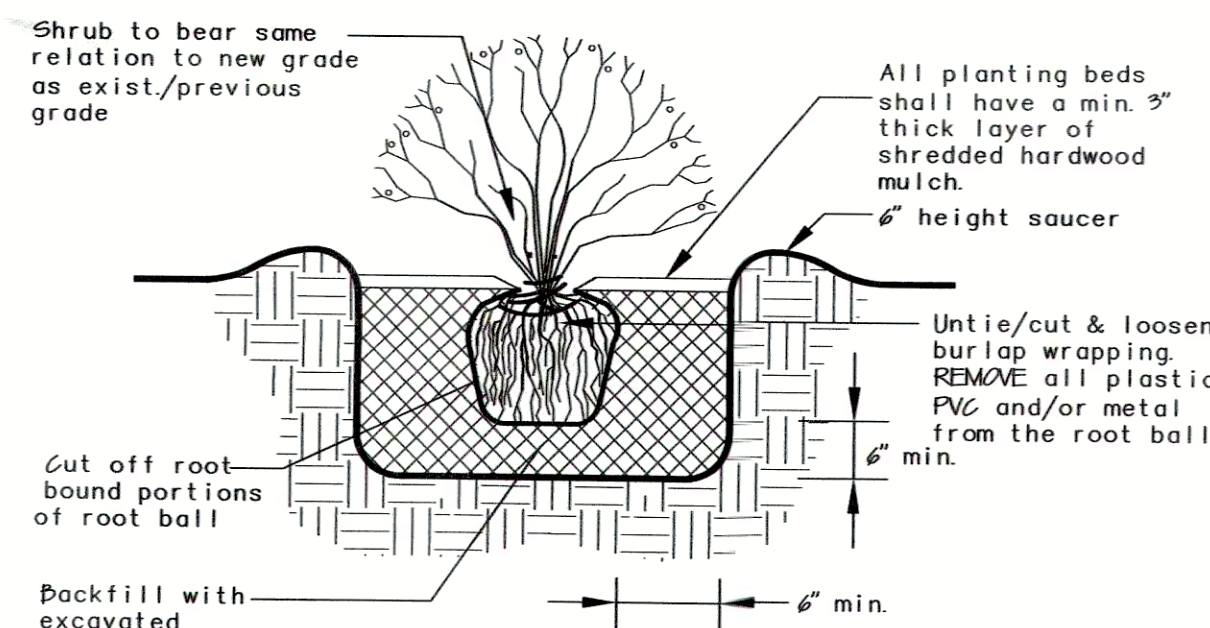

**Shrub Planting**  
NTS.

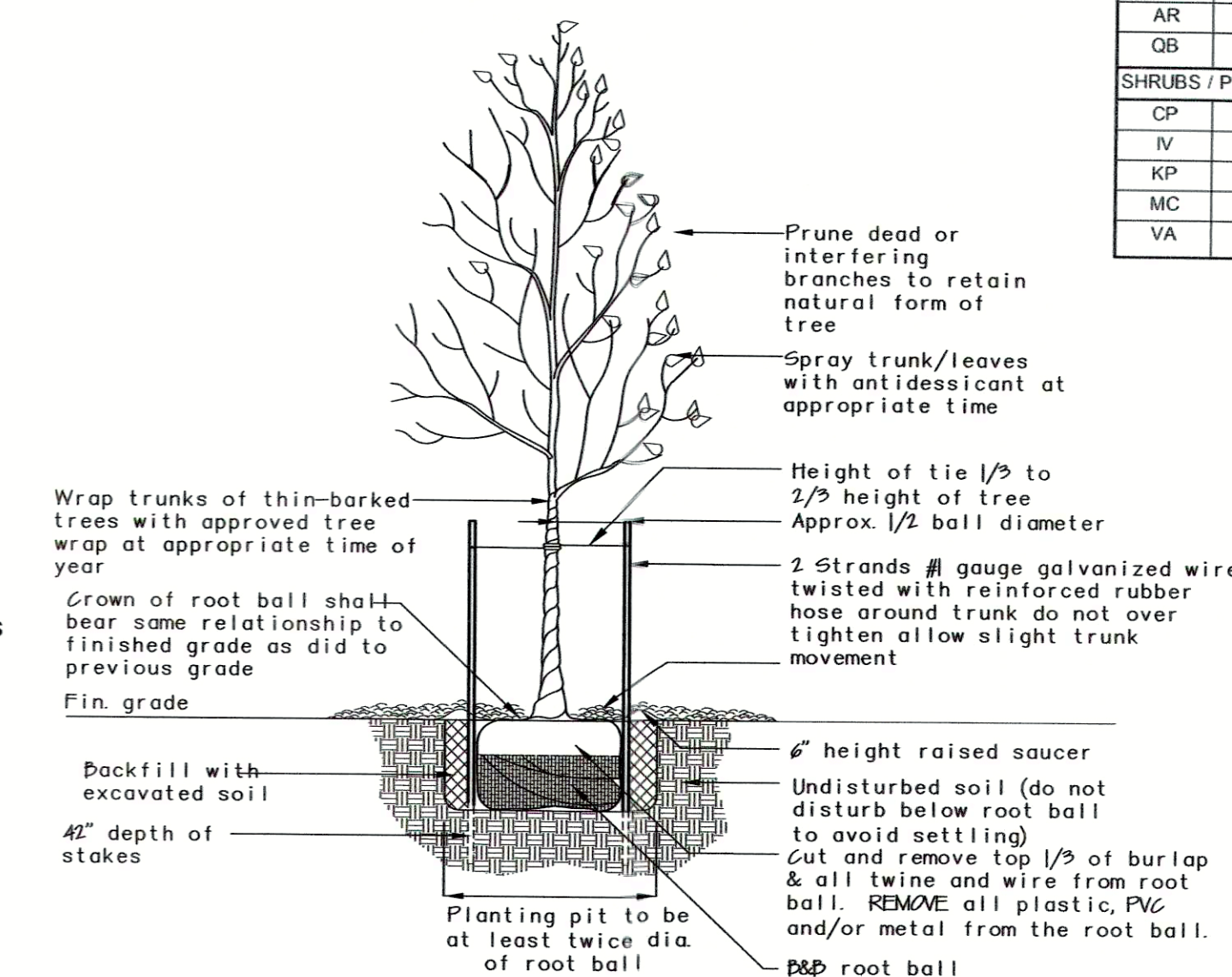

**Deciduous Tree Planting**  
NTS.

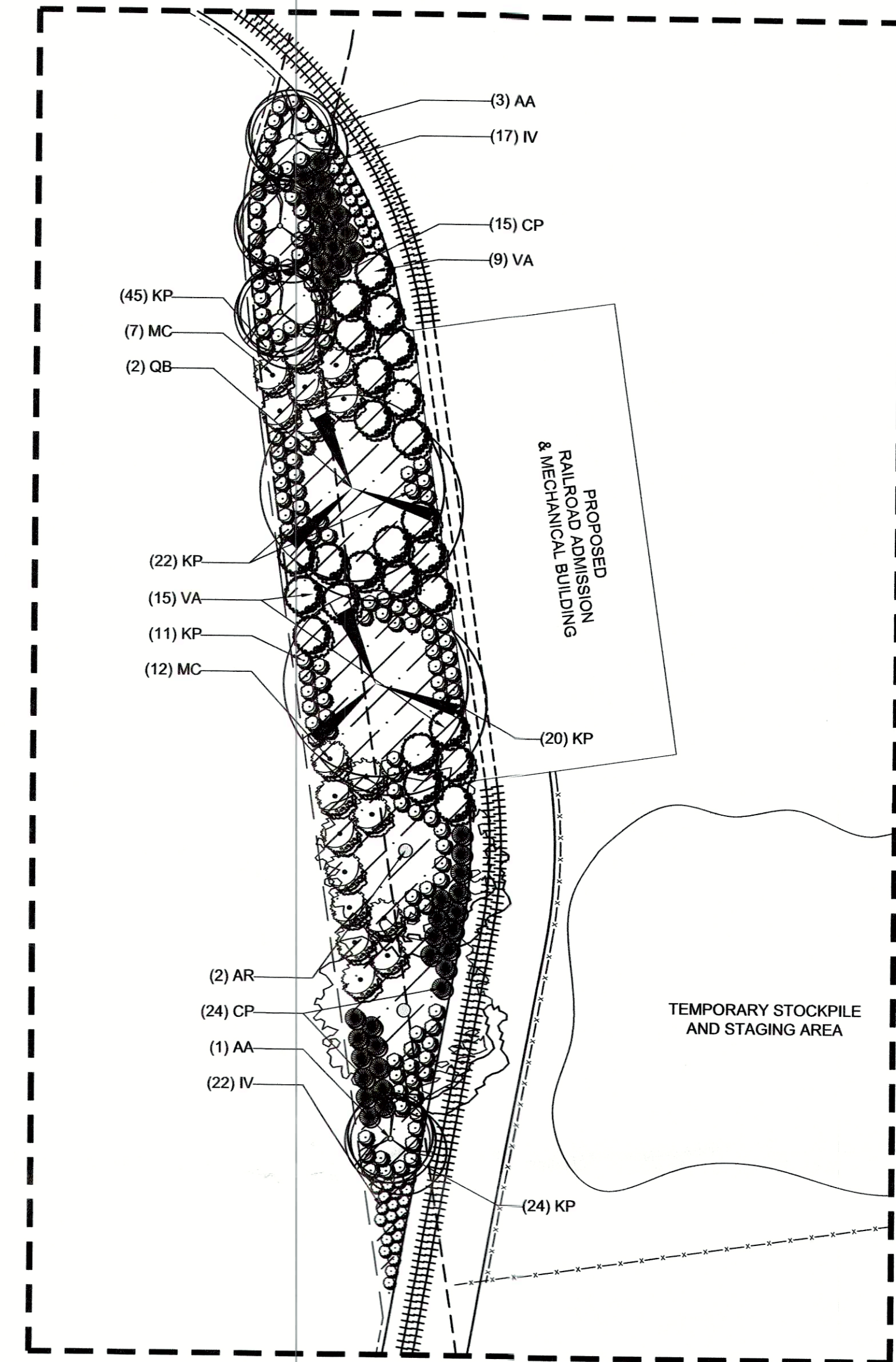

**PART PLAN**  
1" = 20'

PLANT LIST - GREENPORT MINIATURE RR				
SYM	QTY	BOTANICAL NAME (COMMON NAME)	SIZE	SPACING
<b>TREES</b>				
AA	4	Amelanchier arborea (Serviceberry)	6' - 7' Ht.	As Shown
AR	2	Acer rubrum 'October Glory' (October Glory Red Maple)	4" Cal.	30' O.C.
QB	2	Quercus bicolor (Swamp White Oak)	4" Cal.	30' O.C.
<b>SHRUBS / PERENNIALS</b>				
CP	39	Carex pensylvanica (Pennsylvania Sedge)	3 Gal. Cont.	36" O.C.
IV	39	Iris versicolor (Northern Blueflag)	1 Gal. Cont.	24" O.C.
KP	136	Kalmia latifolia (Mountain Laurel)	#3 Cont.	5" O.C.
MC	19	Morella carolinensis (Bayberry)	#3 Cont.	6" O.C.
VA	24	Viburnum acerifolium (Maple-leaved Viburnum)	#5 Cont.	7" O.C.

NYSDEC  
APPROVED AS PER TERMS  
AND CONDITIONS OF  
PERMIT NO. 507  
DATE 5/27

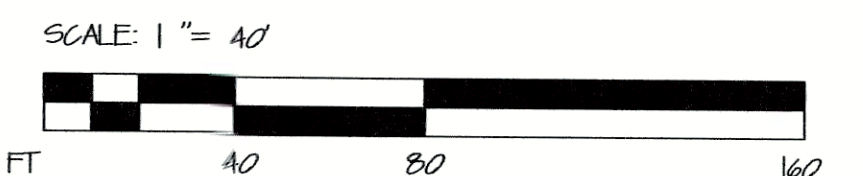

**MOORE'S WOODS  
MINIATURE RAILROAD**

**RDA Landscape Architecture, PC**  
Site Planning • Sports Design • Landscape Design  
220 Lake Ave., Suite 2, St. James, NY 11780  
Tel: (631) 979-5600 ~ Fax: (631) 979-8590  
E-mail: info@rdainc.com  
Web Site: www.rdainc.com  
Robert S. Remauer, R.L.A.  
NYS Lic. No. 1504



**VILLAGE OF GREENPORT**  
236 THIRD STREET  
GREENPORT, NY 11944  
P: 631.477.0248 F: 631.477.1707

DATE: JUNE 6, 2019

SCALE: 1" = 40'-0"

DRAWN BY: GMP

LANDSCAPE PLAN







